

# CF OK

Data sheet - rev. 1.0

## Rod Ends - Tescubal OK

Self-lubricating rod ends, female thread, series K, DIN ISO 12240-4, maintenance free

### FEATURES AND ADVANTAGES

- **HOUSING:** up to size 12 automatic steel 11SMnPb30 (1.0718), from size 14 carbon steel C40 (1.1186), galvanized surface free of Cr VI
- **OUTER RING:** sintered steel impregnated with high efficiency lubricating fluid
- **INNER RING:** tempered, ground and polished steel for bearings 100Cr6 (1,3505)
- **MAINTENANCE:** maintenance free
- **TEMPERATURE RANGE:** -30° C to +120° C
- **USE & MAINTENANCE :** [see this page](#)
- **STATIC LOAD SERVICE LIFE :** [see this page](#)
- **TOLERANCES :** [see this page](#)

### COMPONENTS AND DIMENSIONS

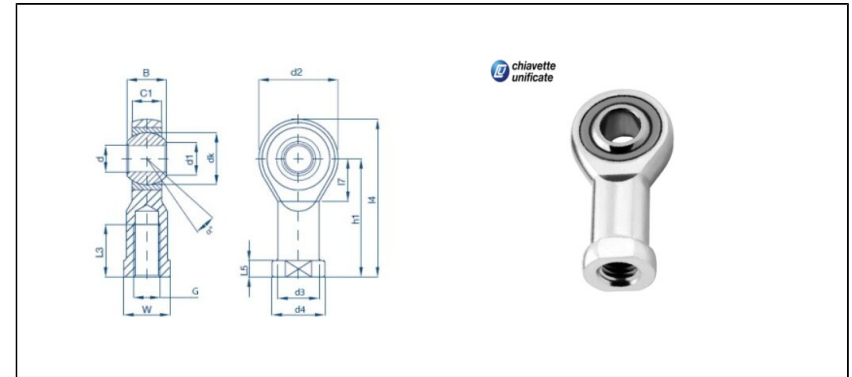

SCAN ME!



myRollon

Type		Measurements [mm]															Tilt angle	Rotational speed limit	Axial factor	Basic load rating		Radial clearance	Weight	
Right hand thread	Left hand thread	d	G	B	C1	h/h1	d1	d2	d3	d4	dk	I1/I3	I2/I4	I5	I7	W	$\alpha$ (°)	$n_{max}$ (min <sup>-1</sup> )	Y	Y0	dyn C (kN)	stat C0 (kN)	CN ( $\mu$ m)	kg
CF6 OK M6	CFL6 OK M6	6	M6	9	6.75	30	8.9	20	10	13	12.7	12	40	5	11	11	13	-	-	-	7.1	8.6	5-50	0.03
CF8 OK M8	CFL8 OK M8	8	M8	12	9	36	10.4	24	12.5	16	15.87	16	48	5	13	14	14	-	-	-	12.1	14.4	7-61	0.05
CF10 OK M10x1.25	CFL10 OK M10x1.25	10	M10x1.25	14	10.5	43	12.9	28	15	19	19.05	20	57	6.5	15	17	13	-	-	-	17.1	20.2	7-61	0.08
CF10 OK M10	CFL10 OK M10	10	M10	14	10.5	43	12.9	28	15	19	19.05	20	57	6.5	15	17	13	-	-	-	17.1	20.2	7-61	0.08
CF12 OK M12	CFL12 OK M12	12	M12	16	12	50	15.4	32	17.5	22	22.22	22	66	6.5	17	19	13	-	-	-	23	23	8-75	0.11
CF12 OK M12x1.25	CFL12 OK M12x1.25	12	M12x1.25	16	12	50	15.4	32	17.5	22	22.22	22	66	6.5	17	19	13	-	-	-	23	23	8-75	0.11
CF16 OK M16x1.5	CFL16 OK M16x1.5	16	M16x1.5	21	15	64	19.3	42	22	27	28.57	28	85	8	23	22	15	-	-	-	37.3	38.4	8-75	0.22
CF16 OK M16	CFL16 OK M16	16	M16	21	15	64	19.3	42	22	27	28.57	28	85	8	23	22	15	-	-	-	37.3	38.4	8-75	0.22

# ROTATIONAL UNITS