

# BEFN

Data sheet - rev. 1.0

## Rod Ends - Classic Line

Rod ends with pressed spherical-plain bearing, female thread, series K, DIN ISO 12240-4 & 8139, maintenance required

## FEATURES AND ADVANTAGES

- **HOUSING:** 17Cr3 forged steel, tempered, surface galvanized, free of Cr VI
- **OUTER RING:** bearing brass, oil groove and drill holes
- **JOINT BALL:** 100Cr6 ball bearing steel, hardened, ground, polished and hard chromium plated
- **MAINTENANCE:** maintenance required, oiled on delivery, initial lubrication by the user
- **GREASE NIPPLE:** DIN 3405 D1/A, from size 6 grease nipple on pos. 1
- **TEMPERATURE RANGE:** -40° C to +110° C
- **USE & MAINTENANCE :** [see this page](#)
- **STATIC LOAD SERVICE LIFE :** [see this page](#)
- **TOLERANCES :** [see this page](#)

## COMPONENTS AND DIMENSIONS

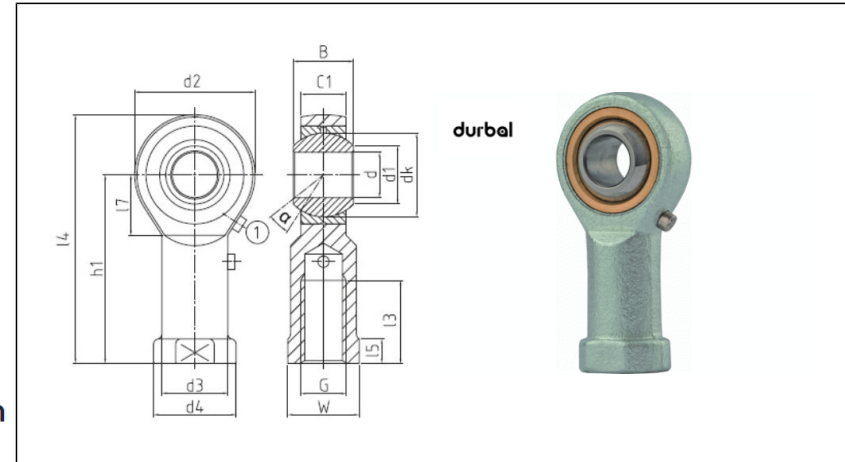

Type		Measurements [mm]															Tilt angle	Rotational speed limit	Axial factor		Basic load rating		Radial clearance	Weight
Right hand thread	Left hand thread	d	G	B	C1	h/h1	d1	d2	d3	d4	dk	l1/13	l2/14	l5	l7	W	$\alpha$ (°)	$n_{max}$ (min <sup>-1</sup> )	Y	Y0	dyn C (kN)	stat C0 (kN)	CN (µm)	kg
BEFN 05 - 21 - 501	BEFN 05 - 21 - 502	5	M4	8	6	27	7.7	18	9	11	11.06	10	36	4	10	9	13	-	-	-	2.4	4.3	20-60	0.02
BEFN 05 - 20 - 501	BEFN 05 - 20 - 502	5	M5	8	6	27	7.7	18	9	11	11.06	10	36	4	10	9	13	-	-	-	2.4	4.3	20-60	0.02
BEFN 06 - 20 - 501	BEFN 06 - 20 - 502	6	M6	9	6.75	30	8.9	20	10	13	12.65	12	40	5	10	11	13	-	-	-	3	6.1	20-60	0.22
BEFN 08 - 20 - 501	BEFN 08 - 20 - 502	8	M8	12	9	36	10.3	24	12.5	16	15.82	16	48	5	12	14	13	-	-	-	4.8	11.2	20-60	0.05
BEFN 10 - 21 - 501	BEFN 10 - 21 - 502	10	M10x1.25	14	10.5	43	12.9	28	15	19	19	20	57	6.5	15	17	13	-	-	-	5.8	17.8	40-90	0.08
BEFN 10 - 20 - 501	BEFN 10 - 20 - 502	10	M10	14	10.5	43	12.9	28	15	19	19	20	57	6.5	15	17	13	-	-	-	5.8	17.8	40-90	0.08
BEFN 12 - 20 - 501	BEFN 12 - 20 - 502	12	M12	16	12	50	15.4	32	17.5	22	22.17	22	66	6.5	16	19	13	-	-	-	7	23	40-90	0.1
BEFN 12 - 21 - 501	BEFN 12 - 21 - 502	12	M12x1.25	16	12	50	15.4	32	17.5	22	22.17	22	66	6.5	16	19	13	-	-	-	7	23	40-90	0.1
BEFN 14 - 20 - 501	BEFN 14 - 20 - 502	14	M14	19	13.5	57	16.8	36	20	25	25.35	25	75	8	20	22	15	-	-	-	10	27.6	40-90	0.16
BEFN 16 - 21 - 501	BEFN 16 - 21 - 502	16	M16x1.5	21	15	64	19.3	42	22	27	28.52	28	85	8	22	22	15	-	-	-	11.4	38.4	50-110	0.22
BEFN 16 - 20 - 501	BEFN 16 - 20 - 502	16	M16	21	15	64	19.3	42	22	27	28.52	28	85	8	22	22	15	-	-	-	11.4	38.4	50-110	0.22
BEFN 18 - 20 - 501	BEFN 18 - 20 - 502	18	M18x1.5	23	16.5	71	21.8	46	25	31	31.7	32	94	10	24	27	15	-	-	-	17.6	46.5	50-110	0.32
BEFN 20 - 20 - 501	BEFN 20 - 20 - 502	20	M20x1.5	25	18	77	24.3	50	27.5	34	34.87	33	102	10	26	30	15	-	-	-	20	46.1	50-110	0.42
BEFN 22 - 20 - 501	BEFN 22 - 20 - 502	22	M22x1.5	28	20	84	25.8	54	30	38	38.05	37	111	12	26	32	105	-	-	-	22.8	61.4	60-120	0.54
BEFN 25 - 20 - 501	BEFN 25 - 20 - 502	25	M24x2	31	22	94	29.5	60	33.5	42	42.8	42	124	12	30	36	15	-	-	-	28	73.2	60-120	0.73
BEFN 30 - 20 - 501	BEFN 30 - 20 - 502	30	M30x2	37	25	110	34.8	70	40	50	50.75	51	145	15	35	41	15	-	-	-	36	96	60-120	1.1
BEFN 30 - 21 - 501	BEFN 30 - 21 - 502	30	M27x2	37	25	110	34.8	70	40	50	50.75	51	145	15	35	41	15	-	-	-	36	96	60-120	1.1

# ROTATIONAL UNITS