

# DSI-T/K

Data sheet - rev. 1.0

## Rod Ends - Basic Line

Rod ends with pressed spherical-plain bearing, steel/PTFE, series K, female thread, according to DIN ISO 12240-4 & 8139, maintenance free

## FEATURES AND ADVANTAGES

- **HOUSING:** C45 forged heat-treated steel, surface galvanized, free of Cr VI
- **OUTER RING:** bearing brass, lined with bronze – PTFE – composite
- **JOINT BALL:** 100Cr6 ball bearing steel, hardened, ground, polished
- **MAINTENANCE:** maintenance free
- **TEMPERATURE RANGE:** -40° C to +200° C
- **USE & MAINTENANCE :** [see this page](#)
- **STATIC LOAD SERVICE LIFE :** [see this page](#)
- **TOLERANCES :** [see this page](#)

## COMPONENTS AND DIMENSIONS

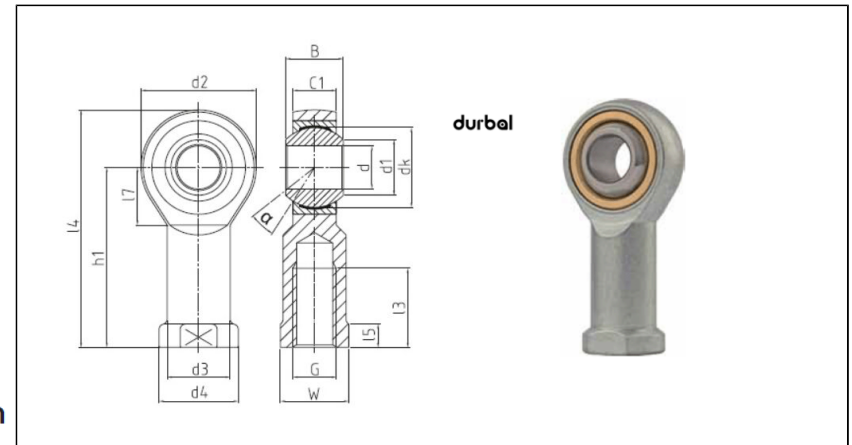

Type		Measurements [mm]															Tilt angle	Rotational speed limit	Axial factor	Basic load rating		Radial clearance	Weight	
Right hand thread	Left hand thread	d	G	B	C1	h/h1	d1	d2	d3	d4	dk	l1/l3	l2/l4	l5	l7	W	α (°)	n <sub>max</sub> (min <sup>-1</sup> )	Y	Y0	dyn C (kN)	stat C0 (kN)	CN (µm)	kg
DSI 05 T/K	DSIL 05 T/K	5	M5	8	6	27	7.7	18	8.5	11	11.1	10	36	4	9	9	13	-	-	-	8.3	9.6	0-32	0.02
DSI 05 T/K M4	DSIL 05 T/K M4	5	M4x0,7	8	6	27	7.7	18	8.5	11	11.1	10	36	4	9	9	13	-	-	-	8.3	9.6	0-32	0.02
DSI 06 T/K	DSIL 06 T/K	6	M6	9	6.75	30	8.9	20	10	13	12.7	12	40	5	11	11	13	-	-	-	11	8.6	0-32	0.02
DSI 08 T/K	DSIL 08 T/K	8	M8	12	9	36	10.3	24	12.5	16	15.88	16	48	5	13	14	14	-	-	-	19	14.4	0-32	0.05
DSI 10 T/K	DSIL 10 T/K	10	M10	14	10.5	43	12.9	28	15	19	19.05	20	57	6.5	14	17	13	-	-	-	27.1	20.2	0-32	0.08
DSI 10 T/K M10x1.25	DSIL 10 T/K M10x1.25	10	M10x1.25	14	10.5	43	12.9	28	15	19	19.05	20	57	6.5	14	17	13	-	-	-	27.1	20.2	0-32	0.08
DSI 12 T/K M12x1.25	DSIL 12 T/K M12x1.25	12	M12x1.25	16	12	50	15.4	32	17.5	22	22.23	22	66	6.5	16	19	13	-	-	-	36.7	23	0-32	0.1
DSI 12 T/K	DSIL 12 T/K	12	M12	16	12	50	15.4	32	17.5	22	22.23	22	66	6.5	16	19	13	-	-	-	36.7	23	0-32	0.1
DSI 14 T/K	DSIL 14 T/K	14	M14	19	13.5	57	16.8	36	20	25	25.4	25	75	8	18	22	16	-	-	-	47.6	25.9	0-40	0.16
DSI 14 T/K M14x1.5	DSIL 14 T/K M14x1.5	14	M14x1.5	19	13.5	57	16.8	36	20	25	25.4	25	75	8	18	22	16	-	-	-	47.6	25.9	0-40	0.16
DSI 16 T/K M16x1.5	DSIL 16 T/K M16x1.5	16	M16x1.5	21	15	64	19.3	42	22	27	28.58	28	85	8	21	22	15	-	-	-	60	36	0-40	0.22
DSI 16 T/K	DSIL 16 T/K	16	M16	21	15	64	19.3	42	22	27	28.58	28	85	8	21	22	15	-	-	-	60	36	0-40	0.22
DSI 18 T/K	DSIL 18 T/K	18	M18x1.5	23	16.5	71	21.8	44	25	31	31.75	32	93	10	22	27	15	-	-	-	73.8	43.6	0-40	0.32
DSI 20 T/K	DSIL 20 T/K	20	M20x1.5	25	18	77	24.3	50	27.5	34	34.86	33	102	10	25	30	14	-	-	-	89	43.2	0-40	0.42
DSI 22 T/K	DSIL 22 T/K	22	M22x1.5	28	20	84	25.8	54	30	38	38.1	37	111	12	27	32	15	-	-	-	108.6	57.6	0-50	0.54
DSI 25 T/K	DSIL 25 T/K	25	M24x2	31	22	94	29.5	60	33.5	42	42.86	42	124	12	30	36	15	-	-	-	135	68.6	0-50	0.72
DSI 30 T/K	DSIL 30 T/K	30	M30x2	37	25	110	34.8	70	40	50	50.8	51	145	15	35	41	17	-	-	-	182.9	90	0-50	1.1
DSI 30 T/K M27x2	DSIL 30 T/K M27x2	30	M27x2	37	25	110	34.8	70	40	50	50.8	51	145	15	35	41	17	-	-	-	182.9	90	0-50	1.1
DSI 35 T/K	DSIL 35 T/K	35	M36x2	43	28	125	37.7	81	46	58	57.15	56	165.5	17	40	50	16	-	-	-	231.5	121	0-60	1.6
DSI 40 T/K	DSIL 40 T/K	40	M42x2	49	33	142	45.2	91	53	65	66.67	60	187.5	19	45	55	17	-	-	-	319.7	126.7	0-60	2.4
DSI 50 T/K	DSIL 50 T/K	50	M48x2	60	45	160	56.6	117	65	75	82.5	65	218.5	23	58	65	12	-	-	-	544.5	291.6	0-60	5

# ***ROTATIONAL UNITS***