

# BEFN Niro

Data sheet - rev. 1.0

## Rod Ends - Classic Line Stainless Steel

Rod ends in stainless steel with pressed spherical-plain bearing, female thread, series K, DIN ISO 12240-4 & 8139, maintenance required

### FEATURES AND ADVANTAGES

- **HOUSING:** AISI 304 stainless steel, rolled thread, surface electropolished
- **OUTER RING:** bearing brass, oil groove and drill holes
- **JOINT BALL:** Stainless steel, hardened, ground, polished
- **MAINTENANCE:** maintenance required, oiled on delivery, initial lubrication by the user
- **GREASE NIPPLE:** DIN 3405 D1/A, from size 6 grease nipple on pos. 1
- **TEMPERATURE RANGE:** -40° C to +110° C
- **USE & MAINTENANCE :** [see this page](#)
- **STATIC LOAD SERVICE LIFE :** [see this page](#)
- **TOLERANCES :** [see this page](#)

### COMPONENTS AND DIMENSIONS

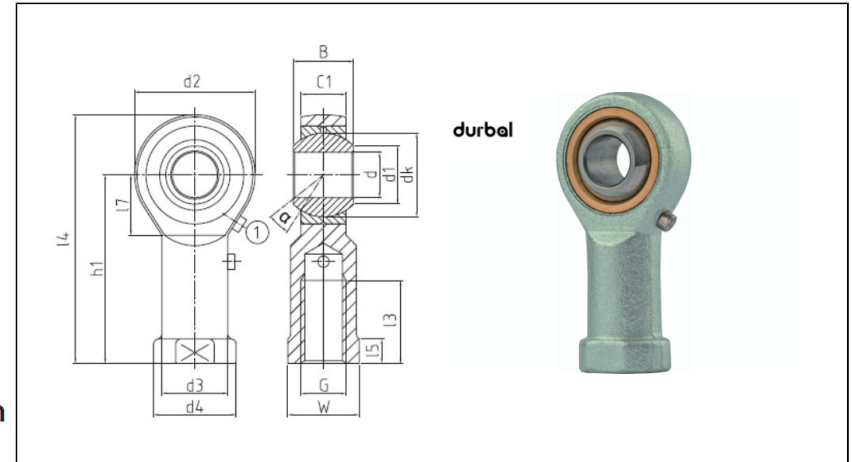

Type		Measurements [mm]															Tilt angle	Rotational speed limit	Axial factor		Basic load rating		Radial clearance	Weight
Right hand thread	Left hand thread	d	G	B	C1	h/h1	d1	d2	d3	d4	dk	l1/13	l2/14	l5	l7	W	$\alpha$ (°)	$n_{max}$ (min <sup>-1</sup> )	Y	Y0	dyn C (kN)	stat C0 (kN)	CN (µm)	kg
BEFN 05 - 81 - 501	BEFN 05 - 81 - 502	5	M4	8	6	27	7.7	18	9	11	11.06	10	36	4	10	9	13	-	-	-	2	4	20-60	0.02
BEFN 05 - 80 - 501	BEFN 05 - 80 - 502	5	M5	8	6	27	7.7	18	9	11	11.06	10	36	4	10	9	13	-	-	-	2	4	20-60	0.02
BEFN 06 - 80 - 501	BEFN 06 - 80 - 502	6	M6	9	6.75	30	8.9	20	10	13	12.65	12	40	5	10	11	13	-	-	-	2.5	5	20-60	0.02
BEFN 08 - 80 - 501	BEFN 08 - 80 - 502	8	M8	12	9	36	10.3	24	12.5	16	15.82	16	48	5	12	14	13	-	-	-	3.6	7.9	20-60	0.05
BEFN 10 - 81 - 501	BEFN 10 - 81 - 502	10	M10x1.25	14	10.5	43	12.9	28	15	19	19	20	57	6.5	15	17	13	-	-	-	4.7	9.7	40-90	0.08
BEFN 10 - 80 - 501	BEFN 10 - 80 - 502	10	M10	14	10.5	43	12.9	28	15	19	19	20	57	6.5	15	17	13	-	-	-	4.7	9.7	40-90	0.08
BEFN 12 - 81 - 501	BEFN 12 - 81 - 502	12	M12x1.25	16	12	50	15.4	32	17.5	22	22.17	22	66	6.5	16	19	13	-	-	-	6.5	11.7	40-90	0.1
BEFN 12 - 80 - 501	BEFN 12 - 80 - 502	12	M12	16	12	50	15.4	32	17.5	22	22.17	22	66	6.5	16	19	13	-	-	-	6.5	11.7	40-90	0.1
BEFN 14 - 80 - 501	BEFN 14 - 80 - 502	14	M14	19	13.5	57	16.8	36	20	25	25.35	25	75	8	20	22	15	-	-	-	8.5	16.7	40-90	0.16
BEFN 16 - 80 - 501	BEFN 16 - 80 - 502	16	M16	21	15	64	19.3	42	22	27	28.52	28	85	8	22	22	15	-	-	-	10.7	19	50-110	0.22
BEFN 16 - 81 - 501	BEFN 16 - 81 - 502	16	M16x1.5	21	15	64	19.3	42	22	27	28.52	28	85	8	22	22	15	-	-	-	10.7	19	50-110	0.22
BEFN 18 - 80 - 501	BEFN 18 - 80 - 502	18	M18x1.5	23	16.5	71	21.8	46	25	31	31.7	32	94	10	24	27	15	-	-	-	15.8	29.3	50-110	0.32
BEFN 20 - 80 - 501	BEFN 20 - 80 - 502	20	M20x1.5	25	18	77	24.3	50	27.5	34	34.87	33	102	10	26	30	15	-	-	-	18.5	33.4	50-110	0.42
BEFN 22 - 80 - 501	BEFN 22 - 80 - 502	22	M22x1.5	28	20	84	25.8	54	30	38	38.05	37	111	12	26	32	15	-	-	-	20.2	38	60-120	0.54
BEFN 25 - 80 - 501	BEFN 25 - 80 - 502	25	M24x2	31	22	94	29.5	60	33.5	42	42.8	42	124	12	30	36	15	-	-	-	26.5	46.7	60-120	0.73
BEFN 30 - 81 - 501	BEFN 30 - 81 - 502	30	M27x2	37	25	110	34.8	70	40	50	50.75	51	145	15	35	41	15	-	-	-	32	60	60-120	1.1
BEFN 30 - 80 - 501	BEFN 30 - 80 - 502	30	M30x2	37	25	110	34.8	70	40	50	50.75	51	145	15	35	41	15	-	-	-	32	60	60-120	1.1

# ROTATIONAL UNITS