

BRF

Data sheet - rev. 1.0

Rod Ends - Premium Line

Rod ends with ball bearing, female thread, series K, DIN ISO 12240-4 & 8139, low maintenance, lubrication possible

FEATURES AND ADVANTAGES

- **HOUSING:** 17Cr3 forged steel, case hardened bearing race, superfinished, surface galvanized, free of Cr VI
- **INNER RING:** 100Cr6 ball bearing steel, hardened, superfinished
- **ROLLING ELEMENT:** 100Cr6 ball bearing steel, hardened, superfinished
- **MAINTENANCE:** low maintenance, lubrication possible, aluminium-complex-soap-grease, approval according to USDA H1
- **GREASE NIPPLE:** DIN 3405 D1/A (until size 10) / DIN 71 412 H1 (from size 12), further grease nipples
- **TEMPERATURE RANGE:** -45° C to +120° C
- **USE & MAINTENANCE :** [see this page](#)
- **STATIC LOAD SERVICE LIFE :** [see this page](#)
- **TOLERANCES :** [see this page](#)

COMPONENTS AND DIMENSIONS

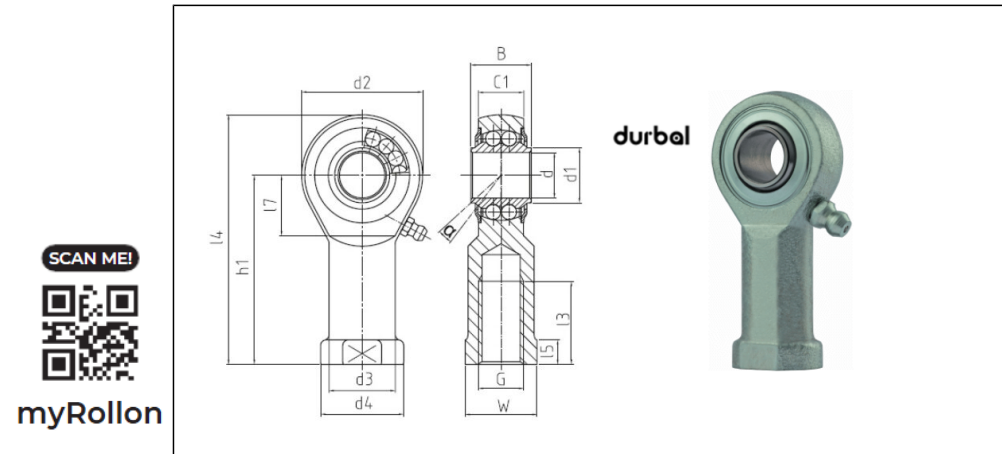

Type		Measurements [mm]															Tilt angle	Rotational speed limit	Axial factor		Basic load rating		Radial clearance	Weight
Right hand thread	Left hand thread	d	G	B	C1	h/h1	d1	d2	d3	d4	dk	l1/l3	l2/l4	l5	l7	W	α (°)	n_{max} (min ⁻¹)	Y	Y0	dyn C (kN)	stat C0 (kN)	CN (µm)	kg
BRF 06 - 00 - 501	BRF 06 - 00 - 502	6	M6	9	6.75	30	9	20	10	13	-	12	40	5	10	11	8	1350	2.09	2.19	2.8	0.7	10-30	0.02
BRF 08 - 00 - 501	BRF 08 - 00 - 502	8	M8	12	9	36	10.4	24	12.5	16	-	16	48	5	12	14	8.5	1300	1.8	1.89	4	1	10-30	0.04
BRF 10 - 00 - 501	BRF 10 - 00 - 502	10	M10	14	10.5	43	12.7	28	15	19	-	20	57	6.5	15	17	8	1225	1.9	1.81	4.5	1.5	10-30	0.07
BRF 10 - 01 - 501	BRF 10 - 01 - 502	10	M10x1.25	14	10.5	43	12.7	28	15	19	-	20	57	6.5	15	17	8	1225	1.9	1.81	4.5	1.5	10-30	0.07
BRF 12 - 00 - 501	BRF 12 - 00 - 502	12	M12	16	12	50	14.6	32	17.5	22	-	22	66	6.5	16	19	7.5	1125	1.74	1.82	5	1.8	10-30	0.11
BRF 12 - 01 - 501	BRF 12 - 01 - 502	12	M12x1.25	16	12	50	14.6	32	17.5	22	-	22	66	6.5	16	19	7.5	1125	1.74	1.82	5	1.8	10-30	0.11
BRF 14 - 00 - 501	BRF 14 - 00 - 502	14	M14	19	13.5	57	17.3	36	20	25	-	25	75	8	20	22	6	1025	2.36	2.48	5.6	2	10-30	0.16
BRF 16 - 00 - 501	BRF 16 - 00 - 502	16	M16	21	15	64	19	42	22	27	-	28	85	8	22	22	8	975	2.24	2.35	6.3	2.4	10-30	0.22
BRF 16 - 01 - 501	BRF 16 - 01 - 502	16	M16x1.5	21	15	64	19	42	22	27	-	28	85	8	22	22	8	975	2.24	2.35	6.3	2.4	10-30	0.22
BRF 18 - 00 - 501	BRF 18 - 00 - 502	18	M18x1.5	23	16.5	71	21.9	46	25	31	-	32	94	10	24	27	8.5	900	2.21	2.31	7.1	2.9	10-30	0.29
BRF 20 - 00 - 501	BRF 20 - 00 - 502	20	M20x1.5	25	18	77	24.3	50	27.5	34	-	33	102	10	26	30	7	825	2.46	2.58	7.9	3.5	10-30	0.37
BRF 22 - 00 - 501	BRF 22 - 00 - 502	22	M22x1.5	28	20	84	25.8	54	30	38	-	37	111	12	26	32	8	725	2.35	2.24	9.3	4	10-30	0.48
BRF 25 - 00 - 501	BRF 25 - 00 - 502	25	M24x2	31	22	94	30.1	64	30	35	-	42	126	10	32	30	5	600	2.02	2.12	11	5.7	10-30	0.57
BRF 30 - 00 - 501	BRF 30 - 00 - 502	30	M30x2	37	25	110	34.5	70	40	50	-	51	145	15	35	41	7.5	450	2.24	2.35	14.2	7.5	10-30	0.98
BRF 35 - 00 - 501	BRF 35 - 00 - 502	35	M36x3	48	35	137	44.5	90	51	65	-	70	182	20	48	50	7	400	1.97	2.07	23.4	11.2	10-30	2.25
BRF 40 - 00 - 501	BRF 40 - 00 - 502	40	M42x3	66	49	170	60	120	58	70	-	80	230	22	70	60	7	360	2.01	2.1	36.7	16.7	10-30	4.65