

DPHS

Data sheet - rev. 1.0

Rod Ends - Basic Line

Rod ends with pressed spherical-plain bearing, series K, female thread, according to DIN ISO 12240-4 & 8139, maintenance required

FEATURES AND ADVANTAGES

- **HOUSING:** forged heat-treated steel, surface galvanized, free of Cr VI
- **OUTER RING:** bearing-brass, oil groove and drill holes
- **JOINT BALL:** ball bearing steel, hardened, ground, polished
- **MAINTENANCE:** maintenance required, oiled on delivery, initial lubrication by the user
- **GREASE NIPPLE:** DIN 3405 D1/A, from size 18 grease nipple on pos. 1, further grease nipple
- **TEMPERATURE RANGE:** -40° C to +110° C
- **USE & MAINTENANCE :** [see this page](#)
- **STATIC LOAD SERVICE LIFE :** [see this page](#)
- **TOLERANCES :** [see this page](#)

COMPONENTS AND DIMENSIONS

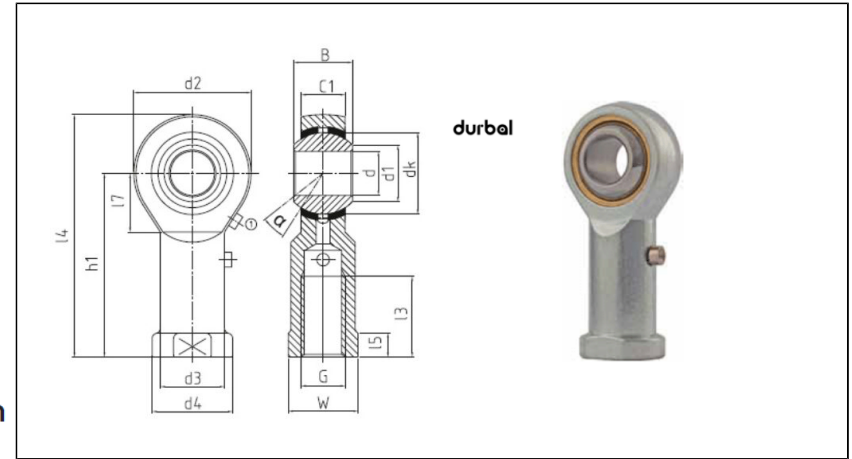

Type		Measurements [mm]															Tilt angle	Rotational speed limit	Axial factor		Basic load rating		Radial clearance	Weight
Right hand thread	Left hand thread	d	G	B	C1	h/h1	d1	d2	d3	d4	dk	l1/13	l2/14	l5	l7	W	α (°)	n _{max} (min ⁻¹)	Y	Y0	dyn C (kN)	stat C0 (kN)	CN (µm)	kg
DPHS 05	DPHSL 05	5	M5	8	6	27	7.7	16	8.5	11	11.1	10	35	4	8	9	13	-	-	-	1.7	4.6	8-55	0.02
DPHS 06	DPHSL 06	6	M6	9	6.75	30	8.9	18	10	13	12.7	12	39	5	9	11	13	-	-	-	2	5.8	8-55	0.02
DPHS 08	DPHSL 08	8	M8	12	9	36	10.3	22	12.5	16	15.88	16	47	5	11	14	14	-	-	-	4.3	9.3	8-55	0.05
DPHS 10 M10x1.25	DPHSL 10 M10x1.25	10	M10x1.25	14	10.5	43	12.9	26	15	19	19.05	20	56	6.5	13	17	13	-	-	-	5.1	11.6	8-55	0.08
DPHS 10	DPHSL 10	10	M10	14	10.5	43	12.9	26	15	19	19.05	20	56	6.5	13	17	13	-	-	-	5.1	11.6	8-55	0.08
DPHS 12	DPHSL 12	12	M12	16	12	50	15.4	30	17.5	22	22.23	22	65	6.5	15	19	13	-	-	-	6.5	13.6	8-55	0.1
DPHS 12 M12x1.25	DPHSL 12 M12x1.25	12	M12x1.25	16	12	50	15.4	30	17.5	22	22.23	22	65	6.5	16	19	13	-	-	-	6.5	13.6	8-55	0.1
DPHS 14 M14x1.5	DPHSL 14 M14x1.5	14	M14x1.5	19	13.5	57	16.8	34	20	25	25.4	25	74	8	17	22	16	-	-	-	8.7	19.2	8-55	0.16
DPHS 14	DPHSL 14	14	M14	19	13.5	57	16.8	34	20	25	25.4	25	74	8	17	22	16	-	-	-	8.7	19.2	8-55	0.16
DPHS 16	DPHSL 16	16	M16	21	15	64	19.3	40	22	27	28.58	28	84	8	20	22	15	-	-	-	10	22.8	8-55	0.22
DPHS 16 M16x1.5	DPHSL 16 M16x1.5	16	M16x1.5	21	15	64	19.3	40	22	27	28.58	28	84	8	20	22	15	-	-	-	10	22.8	8-55	0.22
DPHS 18	DPHSL 18	18	M18x1.5	23	16.5	71	21.8	44	25	31	31.75	32	93	10	22	27	15	-	-	-	14.2	34	8-55	0.32
DPHS 20	DPHSL 20	20	M20x1.5	25	18	77	24.3	50	27.5	34	34.93	33	102	10	25	30	14	-	-	-	17.2	42.5	8-55	0.42
DPHS 22	DPHSL 22	22	M22x1.5	28	20	84	25.8	54	30	38	38.1	37	111	12	27	32	15	-	-	-	19.4	45.6	8-55	0.54
DPHS 25	DPHSL 25	25	M24x2	31	22	94	29.5	60	33.5	42	42.86	42	124	12	30	36	15	-	-	-	24.6	54.4	8-55	0.73
DPHS 30	DPHSL 30	30	M30x2	37	25	110	34.8	70	40	50	50.8	51	145	15	35	41	17	-	-	-	32.1	70.4	8-55	1.1
DPHS 30 M27x2	DPHSL 30 M27x2	30	M27x2	37	25	110	34.8	70	40	50	50.8	51	145	15	35	41	17	-	-	-	32.1	70.4	8-55	1.1

ROTATIONAL UNITS