

PM

Data sheet - rev. 1.0

Rod Ends - Premium Line

Rod ends with ball bearing, male thread, low maintenance, lubrication possible

FEATURES AND ADVANTAGES

- **HOUSING:** 17Cr3 forged steel, case hardened bearing race, superfinished, surface galvanized, free of Cr VI
- **INNER RING:** 100Cr6 ball bearing steel, hardened, superfinished
- **ROLLING ELEMENT:** 100Cr6 ball bearing steel, hardened, superfinished
- **MAINTENANCE:** low maintenance, lubrication possible, aluminium-complex-soap-grease, approval according to USDA H1
- **GREASE NIPPLE:** DIN 3405 D1/A, further grease nipples
- **TEMPERATURE RANGE:** -45° C to +120° C
- **USE & MAINTENANCE :** [see this page](#)
- **STATIC LOAD SERVICE LIFE :** [see this page](#)
- **TOLERANCES :** [see this page](#)

COMPONENTS AND DIMENSIONS

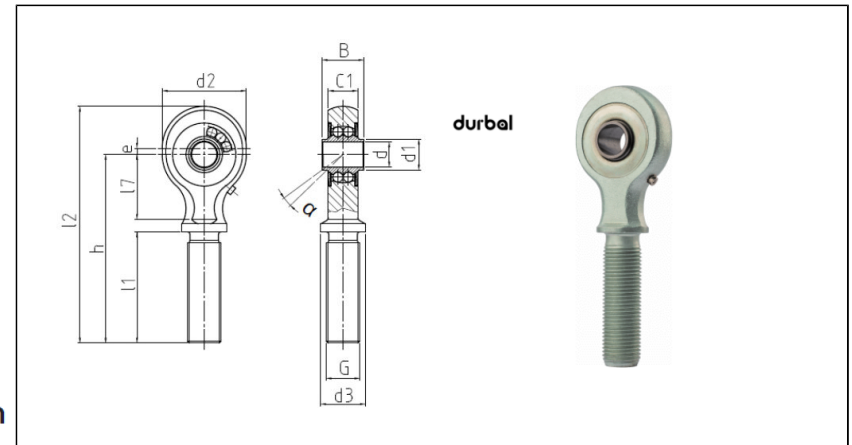

Type		Measurements [mm]															Tilt angle	Rotational speed limit	Axial factor		Basic load rating		Radial clearance	Weight
Right hand thread	Left hand thread	d	G	B	C1	h/h1	d1	d2	d3	d4	dk	l1/l3	l2/l4	l5	l7	W	α (°)	n _{max} (min ⁻¹)	Y	Y0	dyn C (kN)	stat C0 (kN)	CN (µm)	kg
PM 06 - 00 - 501	PM 06 - 00 - 502	6	M10x1	14	10	64	8.5	24	14	-	-	42.5	77.5	-	17	-	10.5	1300	1.28	1.34	2.5	0.8	10-30	0.06
PM 06 - 01 - 501	PM 06 - 01 - 502	6	M10x1	14	10	40.5	8.5	24	14	-	-	19	54	-	17	-	10.5	1300	1.28	1.34	2.5	0.8	10-30	0.06
PM 08 - 00 - 501	PM 08 - 00 - 502	8	M12x1.25	15	10	72	11	30	17	-	-	46.5	89	-	20	-	8.5	1225	1.9	1.81	2.6	1	10-30	0.1
PM 08 - 01 - 501	PM 08 - 01 - 502	8	M12x1.25	15	10	48.5	11	30	17	-	-	23	65.5	-	20	-	8.5	1225	1.9	1.81	2.6	1	10-30	0.09
PM 10 - 00 - 501	PM 10 - 00 - 502	10	M14x1.5	20	14	82	14	36	19	-	-	49.5	102.5	-	28	-	9.5	1100	1.69	1.77	5.1	1.9	10-30	0.17
PM 10 - 01 - 501	PM 10 - 01 - 502	10	M14x1.5	20	14	58.5	14	36	19	-	-	26	79	-	28	-	9.5	1100	1.69	1.77	5.1	1.9	10-30	0.15
PM 12 - 00 - 501	PM 12 - 00 - 502	12	M16x1.5	20	14	90	15	40	21	-	-	53.5	113	-	31	-	7.5	1050	1.81	1.9	5.4	2.1	10-30	0.23
PM 12 - 01 - 501	PM 12 - 01 - 502	12	M16x1.5	20	14	65.5	15	40	21	-	-	29	88.5	-	31	-	7.5	1050	1.81	1.9	5.4	2.1	10-30	0.2
PM 15 - 00 - 501	PM 15 - 00 - 502	15	M20x1.5	20	14	100	19	42	26	-	-	62.5	124	-	30	-	6.5	975	2.07	2.17	5.5	2.4	10-30	0.31
PM 15 - 01 - 501	PM 15 - 01 - 502	15	M20x1.5	20	14	73.5	19	42	26	-	-	36	97.5	-	30	-	6.5	975	2.07	2.17	5.5	2.4	10-30	0.27
PM 17 - 01 - 501	PM 17 - 01 - 502	17	M20x1.5	22	16	78.5	21	48	26	-	-	36	106	-	36	-	7	875	2.35	2.46	5.6	2.7	10-30	0.35
PM 17 - 00 - 501	PM 17 - 00 - 502	17	M20x1.5	22	16	105	21	48	26	-	-	62.5	132.5	-	36	-	7	875	2.35	2.46	5.6	2.7	10-30	0.4
PM 20 - 00 - 501	PM 20 - 00 - 502	20	M24x1.5	24	18	117	24	56	30	-	-	68.5	148.5	-	41	-	5.5	775	2.76	2.9	6.2	3.1	10-30	0.59
PM 20 - 01 - 501	PM 20 - 01 - 502	20	M24x1.5	24	18	89.5	24	56	30	-	-	41	121	-	41	-	5.5	775	2.76	2.9	6.2	3.1	10-30	0.52

ROTATIONAL UNITS